

NOTE: BREAK ALL CORNERS WITH 0.015" (.38 MM) RADIUS UNLESS OTHERWISE NOTED. STANDARD TOLERANCES TO APPLY UNLESS OTHERWISE SPECIFIED.

CUSTOMER PART No.	CAN ART STD.	DIE No. EH05712
DESCRIPTION	3" SCHED. 40 PIPE	PROPOSAL No. H-50143

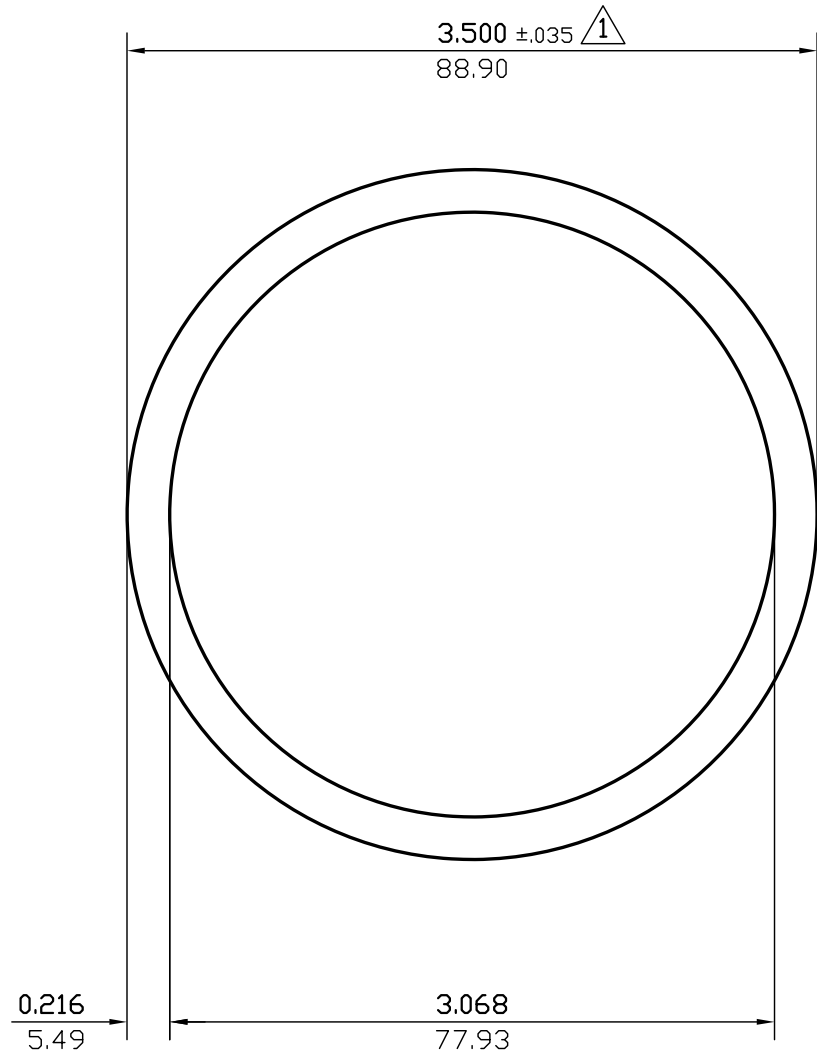

WALL THICKNESS		AS SHOWN		EXCEPT AS SHOWN	
DATE	REV	DESCRIPTION		BY	
03/10/23	2	REMOVED ALLOY		JASON	
07/15/15	1	ADDED ±0.035 TOLERANCE.		PAUL	
EST. AREA	2.228	IN. ²	EST. AREA	1437.731	MM. ²
EST. WT.	2.630	LBS./FT.	EST. WT.	3.913	KG/M.
EST. PER.	20.634	IN.	EST. PER.	524.103	MM.
OUT PER.	10.996	IN.	OUT PER.	279.3	MM.
C.C.D.	3.500	IN.	C.C.D.	88.900	MM.
FACTOR	8	FINISH	M/F	ALLOY & TEMP.	
CKD BY	SCALE	1:1	DWN BY	C.P.	DATE 07/23/2001

CAN ART

ALUMINUM EXTRUSION INC.

85 PARKSHORE DRIVE
BRAMPTON, ONT L6T 5M1
TEL. NO. (905) 791-1464
FAX NO. (905) 791-9151
E-MAIL: canart@canart.com

THIS DRAWING IS NOT NECESSARILY A COPY OF YOUR ORIGINAL. PLEASE APPROVE DIMENSIONS AND TOLERANCES INDICATED. CAN ART ASSUMES NO RESPONSIBILITY EITHER TECHNICAL OR LEGAL FOR HAVING THIS SHAPE MADE. THE CUSTOMER AGREES TO FULLY PROTECT CAN ART ALUMINUM FROM CLAIMS OF OTHERS RESULTING FROM THIS SHAPE.

SIGNED: _____ DATE: _____